



2 Poseidon Bolts

ORDER CODE	BACKSET	FACEPLATE	SPINDLE
AGB2PB35	35mm	Flat 16mm Square Ends	Single 8mm

AGB locks are made in Italy and while relatively uncommon in the UK market their locking positions are generally unique. The Poseidon lock features unique hook boxes.

SPECIFICATION:

- ✓ **Case height:** 220mm
- ✓ **Case Depth:** Backset + 18mm
- ✓ **Centres:** 92mm
- ✓ **Distance between poseidon bolts:** 1410mm
- ✓ **Operation:** Lift lever
- ✓ **Latch reversal:** Push in the latch and a screw will appear in the back of the lockcase. Undo the screw to remove the latch. Reverse, reinsert and replace screw.

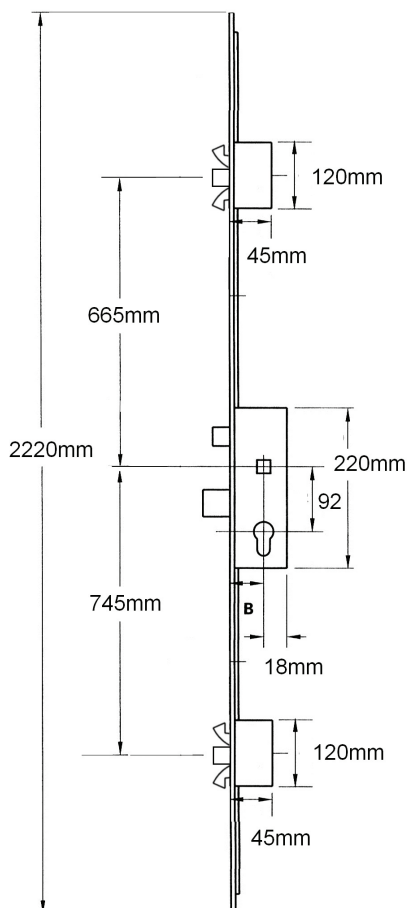

ASSOCIATED PRODUCTS

Order Code	Colour	Lever/Lever
DLMHANLLWH	White	
DLMHANLLSC	Silver	
DLMHANLLBL	Black	
DLMHANLLHG	Brass Effect	
DLMHANLLBC	Chrome	

PVCu keep set
Special order



SHOOTBOLTS

Incompatible