

**WILKA**

2 Wedgebolts

| ORDER CODE | BACKSET | FACEPLATE             | SPINDLE    |
|------------|---------|-----------------------|------------|
| 201635     | 35mm    | Flat 16mm Square Ends | Single 8mm |

This European made lock features wedgebolts at the top and bottom and a regular deadbolt in the centre gearbox.

#### SPECIFICATION:

- ✓ **Case height:** 270mm
- ✓ **Case Depth:** 50mm
- ✓ **Centres:** 92mm
- ✓ **Distance between wedgebolts:** 1470mm
- ✓ **Operation:** Lift lever
- ✓ **Latch reversal:** Push in the latch and undo screw in back of lock case. Then push latch forward, twist and release to reverse.

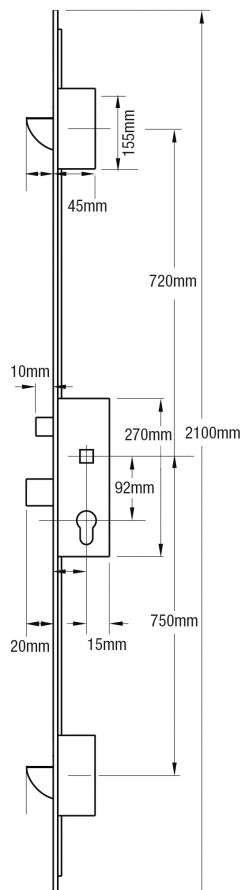

#### ASSOCIATED PRODUCTS

| Order Code | Colour       | Lever/Lever |
|------------|--------------|-------------|
| DLMHANLLWH | White        |             |
| DLMHANLLSC | Silver       |             |
| DLMHANLLBL | Black        |             |
| DLMHANLLHG | Brass Effect |             |
| DLMHANLLBC | Chrome       |             |

| UPVC Keeps  |                       |     |
|-------------|-----------------------|-----|
|             |                       |     |
| Order Code  | Description           | Qty |
| V-CENSTRIKE | Latch & deadbolt keep | 1   |
| V-HSTRIKE   | Pair deadbolt keeps   | 1   |

Keeps listed above suit UPVC Profiles. Refer to keeps chapter for wood and composite door keeps.



#### SHOOTBOLTS

Incompatible

