



2 Hooks & 2 Rollers

Scorpion lock - Standard version - 1390mm between hooks

ORDER CODE	BACKSET	FACEPLATE	SPINDLE
2398251	35mm	Flat 16mm Square Ends	Split 8mm

This Scorpion lock features rollers as well as hooks for compression. If lift lever function is required, use with a solid spindle. 2 versions of this lock are available, with 1390mm and 1250mm between the hooks. This version has 1390mm between the hooks. For the narrow version, see the next page.

SPECIFICATION:

- ✓ **Case height:** 185mm
- ✓ **Case Depth:** 53mm
- ✓ **Centres:** 92mm
- ✓ **Distance between outer rollers:** 1580mm
- ✓ **Distance between inner hooks:** 1390mm
- ✓ **Operation:** Lift lever or split spindle nightlatch
- ✓ **Latch reversal:** Push in latch and a screw will appear in back of lockcase. Undo the screw to remove the latch. Reverse, reinsert and replace screw.
- ✓ **Nightlatch reversal:** Small rectangular slot to side of spindle hole contains a black split pin, insert flat bladed screwdriver and push split pin to opposite side to reverse function.

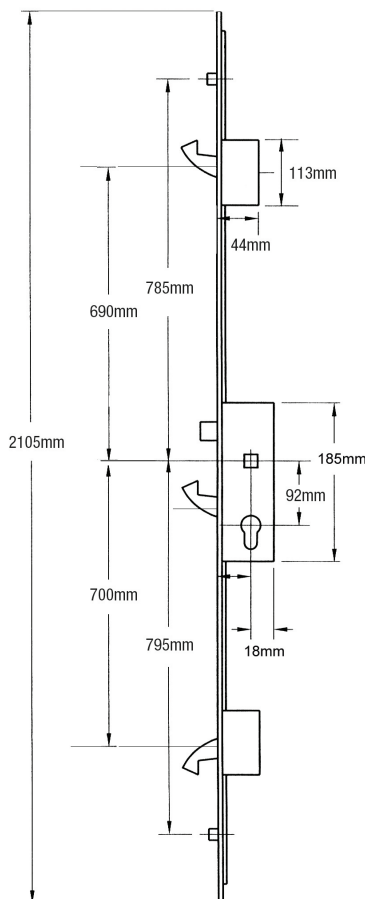

ASSOCIATED PRODUCTS

Order Code	Colour	Lever/Lever
DCHANL92WH	White	
DCHANL92SC	Silver	
DCHANL92BL	Black	
DCHANL92HG	Brass Effect	
DCHANL92BC	Chrome	

Order Code	Colour	Lever/Moveable Pad
DCHANLP92WH	White	
DCHANLP92SC	Silver	
DCHANLP92BL	Black	
DCHANLP92HG	Brass Effect	
DCHANLP92BC	Chrome	

Order Code	Description
4978054	Split spindle for 44mm door
4978055	Split spindle for 56mm door
4978056	Split spindle for 70mm door
4928572	Split spindle for 108mm door
4928571	Split spindle for 120mm door

UPVC Keeps		
		
Order Code	Description	Qty
V-CENSTRIKE	Latch & deadbolt keep	1
V-HSTRIKE	Pair deadbolt keeps	1
V-RMSTRIKE	Pair roller keeps	1



SHOOTBOLTS

Compatible

