

LOCKMASTER®

3 Deadbolts

Option 1 - Deadbolt centres: 718mm/718mm

ORDER CODE	BACKSET	FACEPLATE	SPINDLE
MM3DB35S	35mm	Flat 16mm Square Ends	Single 8mm
LM545S	45mm	Flat 16mm Square Ends	Single 8mm
MM3DB35	35mm	Flat 16mm Square Ends	Double 8mm
LM545	45mm	Flat 16mm Square Ends	Double 8mm

This Lockmaster features 2 deadbolts and is found on both UPVC or timber doors. Please note that the double spindle version is unsprung and should only be used with sprung handles. The associated handles below are all sprung.

SPECIFICATION:

- ✓ **Case height:** 228mm
- ✓ **Case Depth:** Backset + 15mm
- ✓ **Centres:** 92mm (single) 92 / 62mm
- ✓ **Distance between deadbolts:** 1436mm
- ✓ **Operation:** Lift lever or double spindle nightlatch
- ✓ **Latch reversal:** Undo the screw or screws (depending on the model) in the latch to remove. Reverse, reinsert and replace screw(s).

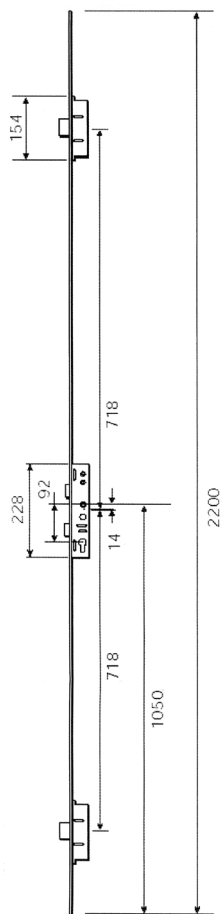

ASSOCIATED PRODUCTS

Order Code	Colour	Lever/Lever
DLMHANLLWH	White	
DLMHANLLSC	Silver	
DLMHANLLBL	Black	
DLMHANLLHG	Brass Effect	
DLMHANLLBC	Chrome	

Order Code	Colour	Lever/Moveable Pad
DLMHANLPWH	White	
DLMHANLPSC	Silver	
DLMHANLPBL	Black	
DLMHANLPHG	Brass Effect	
DLMHANLPBC	Chrome	

Left Hand UPVC Keeps		
		
Order Code	Description	Qty
PAD90021	Latch & deadbolt keep (LH)	1
V-HSTRIKE	Pair deadbolt keeps	1

Right Hand UPVC Keeps		
		
Order Code	Description	Qty
PAD90022	Latch & deadbolt keep (RH)	1
V-HSTRIKE	Pair deadbolt keeps	1

Lever/Pad handles are also available with a snib - See Multipoint Handles chapter.



SHOOTBOLTS

Incompatible

