

FUHR

2 Hooks

Split spindle (S/S)

ORDER CODE	BACKSET	FACEPLATE	SPINDLE
FU859T445SS	45mm	Flat 16mm Square Ends	Split 8mm

Featuring a split spindle, this 859 series also has 2 hooks. Please note that there are no serrations to accept shootbolts on this lock.

SPECIFICATION:

- ✓ **Case height:** 195mm
- ✓ **Case Depth:** Backset + 18mm
- ✓ **Centres:** 92mm
- ✓ **Distance between hooks:** 1490mm
- ✓ **Operation:** Lift lever or split spindle nightlatch
- ✓ **Latch reversal:** Undo the screw in the side of the lock case adjacent to the latch. Remove the latch, reverse, reinsert and replace the screw.
- ✓ **Nightlatch reversal:** Insert the spindle 2/3 of the way in on the internal side and 1/3 of the way in on the external side.

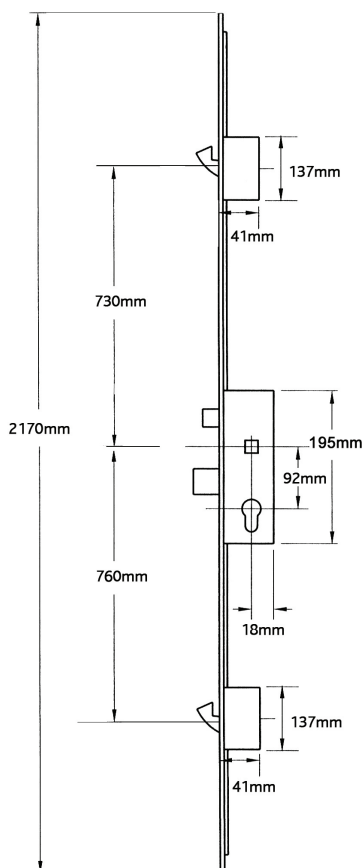

ASSOCIATED PRODUCTS

Order Code	Colour	Lever/Lever
DCHANLL92WH	White	
DCHANLL92SC	Silver	
DCHANLL92BL	Black	
DCHANLL92HG	Brass Effect	
DCHANLL92BC	Chrome	

Order Code	Colour	Lever/Moveable Pad
DCHANLP92WH	White	
DCHANLP92SC	Silver	
DCHANLP92BL	Black	
DCHANLP92HG	Brass Effect	
DCHANLP92BC	Chrome	

UPVC Keeps		
		
Order Code	Description	Qty
V-CENSTRIKE	Latch & deadbolt keep	1
V-HSTRIKE	Pair Hook keeps	1

Keeps listed above suit UPVC Profiles. Refer to keeps chapter for wood and composite door keeps.



SHOOTBOLTS

Incompatible

